

MEMO

From District Lands Officer/Tai Po
Ref. (127) in LM 6 in DLO/TP 351/TRN/59 IV
Tel. No. 2654 1245
Fax. No. 2650 9896
Date 6 MAY 2017

To CE5/MW, MWPMO, HyD
(Attn.: [REDACTED])
Your Ref. (GUWQ) in HYD MWO 11/1/720TH/3/1
Dated 2-5-2017 Fax. No. 2714 5198
Total Pages 4 + 2 Plans

**Application for the Additional Areas of
Simplified Temporary Land Allocation (STLA) - TP 1463**

**Roads (Works, Use and Compensation) Ordinance (Chapter 370)
PWP Item No. 6720TH
Widening of Tolo Highway/Fanling Highway
between Island House Interchange and Fanling – Stage 2 (“the Project”)**

**Contract No. HY/2012/06
Widening of Fanling Highway – Tai Hang to Wo Hop Shek Interchange**

- Locations:**
- 1) The area from Tong Hang Tung to Kiu Tau Road, Tai Po**
 - 2) The area near Yuen Leng, Tai Po**
 - 3) The area near Nam Wa Po, Tai Po**

Approval is hereby given for the temporary allocation to you of the areas of Government land at (i) the area from Tong Hang Tung to Kiu Tau Road, (ii) the area near Yuen Leng, and (iii) the area near Nam Wa Po (excluding any public road or street and any land allocated to other departments) as shown coloured blue on the attached plans (Annex I and Annex II respectively) for the captioned project, subject to the following engineering conditions: -

- (i) The sites are allocated to you for the period from 28 November 2013 to 31 December 2019 only.
- (ii) The areas as shown coloured blue on the attached plans shall not be used for any purpose other than the works sites and works areas in connection with the captioned project.
- (iii) Excavation within the sites in connection with the aforesaid purposes is permitted.
- (iv) No site formation or general disturbance of existing site conditions shall be undertaken without the prior consent in writing of the appropriate authority. Site investigations may be undertaken without such written approval.
- (v) No drain or nullah, water pipe, sewer, cable or any other existing site works or installations whatsoever on the sites shall be interfered with without the written consent of the appropriate authority who shall impose such conditions regarding removal, diversion or reinstatement elsewhere as may be required and paid for as part of the project.

- (vi) Damage or obstruction caused to any nullah, drain, water main, cable or other installation within or adjoining the sites shall be made good at the cost of the project and to the satisfaction of the appropriate authority.
- (vii) Any damage done to adjoining public roads shall be made good to the satisfaction of the appropriate authority and paid for as part of the project.
- (viii) All storm or rain water from the sites including any access road thereto shall be conveyed to the sea or the nearest stream course, catchpit, channel or storm water drain. All temporary and permanent works shall be paid for from the project vote and carried out in such a manner that no damage or nuisance is caused by storm water or rain water to adjacent property and any claims arising out of damage or nuisance caused by storm water or rain water shall be paid for at the cost of the project.
- (ix) Application should be made direct to the appropriate authority should any water supply or drainage connection be required, and if a connection can be made, it shall be paid for as part of the project.
- (x) No right of ingress or egress to or from the sites for the passage of motor vehicles will be permitted except with the consent of AC for T/NT, TD and subject to any conditions he may impose.
- (xi) No structure shall be erected on the sites other than those as may be required to facilitate the use and enjoyment of the areas for the approved user and authorized by the District Lands Officer.
- (xii) Immediately upon handing over the sites, adequate fencing or other works shall be carried out to the satisfaction of the District Lands Officer and at the cost of the project to prevent illegal occupation of or dumping on the sites.
- (xiii) No trees growing on the sites shall be interfered with or removed without the prior written consent of the District Lands Officer who may in granting consent impose such conditions as to replanting as he may deem appropriate. All necessary steps shall be taken to protect the general environment, landscape and plants within and adjoining the sites.
- (xiv) Portions of the works sites may be allocated to other government departments for works, you may wish to liaise with relevant allocatees for interfacing issues.
- (xv) All reasonable measures shall be taken to prevent deterioration of the general environment by the suppression of noise, dust, smells and the discharge of any effluent, rubbish, debris etc. whatsoever from the sites.
- (xvi) On completion of construction or at the expiry or cancellation or sooner determination of the allocation, the sites or any part thereof shall be handed back free of structures and debris and cleared of all occupation in a condition to the satisfaction of the District Lands Officer who may require the sites to be reinstated and fenced to his satisfaction at the cost of the project.

2. This allocation is made without prior circulation to other Government departments and is subject to your satisfying the requirements of any other necessary departments. If any other department raises an objection to the proposed allocation, the allocation may be suspended pending consideration of such objection or query and may be withdrawn if any objection is upheld or may be amended as appropriate.

3. You should be aware that the allocated areas affect the following land status and it is necessary for you to approach the relevant parties shown below for consent before commencement of your works:

<u>DLO/TP Ref. of the Limits</u>	<u>Area/Project affected</u>	<u>Parties to be consulted</u>
347/TRN/59 and 610/65/03	Drainage Improvement in Northern New Territories – Package A the Proposed Drainage Improvement Works and Ancillary Road Works for Ma Wat River and Drainage Crossings under Railways (Kau Lung Hang and Hong Lok Yuen Sections) (PWP Item No. 112CD)	DSD
365/TRN/59, 543/177/06 and STLA TP-953	Cycling Tracks Connecting NWNT and NENT – Sheung Shui to Ma On Shan Section (PWP Item No. 271RS)	CEDD
654/65/08 Temporary Resumption Limit	Proposed Works Site for North District Sewerage, Stage 2 Phase 1– Southern Truck Sewer Between Yuen Leng and Wo Hop Shek	DSD

4. You should also provide a set of coloured photos (size 4R in hardcopy) showing the sites/alignment in full from different angles :

- (a) before commencement of works (within one month); and
- (b) after completion of works (within one month).

5. In the interests of a more efficient allocation process, no formal allocation plan will be prepared. Copy of the plan showing the works limit are attached to this memorandum.

6. Grateful if copy addressees would consider this allocation. Agreement will be deemed if I do not hear anything from you within 2 weeks from the date hereof.



for District Lands Officer/Tai Po

Encl.

c.c. DPO/ST, TP&N, Plan D	Fax 2696 2377
CE/BCP, CEDD	3547 1659
CGE/ME, GEO, CEDD	2714 0245
PM/NTE, CEDD	2739 0076
DO/TP, HAD	2652 1187
CE/NTE, WSD	2354 5737
CE/MN, DSD	2770 4761
CE/PM, DSD	2827 8526
AC for T/NT, TD	2381 3799
CHE/NTE, HyD	2714 5228
DAFC	2311 3731
DEHS/TP, FEHD	2650 1171
DLCS	2695 3886
D of FS	2739 8775
C for P (SSP ADM NTN)	2665 2521
RNG/EPD	2685 1155
DLO/N, Lands D	2675 9224
CGE/SM, Lands D	2116 0822
SLS/TP, Lands D	2650 5299
M/SCU (NTE1), Lands D	2699 6808
M/CU(2), Lands D	2660 9770

DWP Item No. 6720TH Widening of Tolo Highway/Fanling Highway between Island House Interchange and Fanling – Stage 2

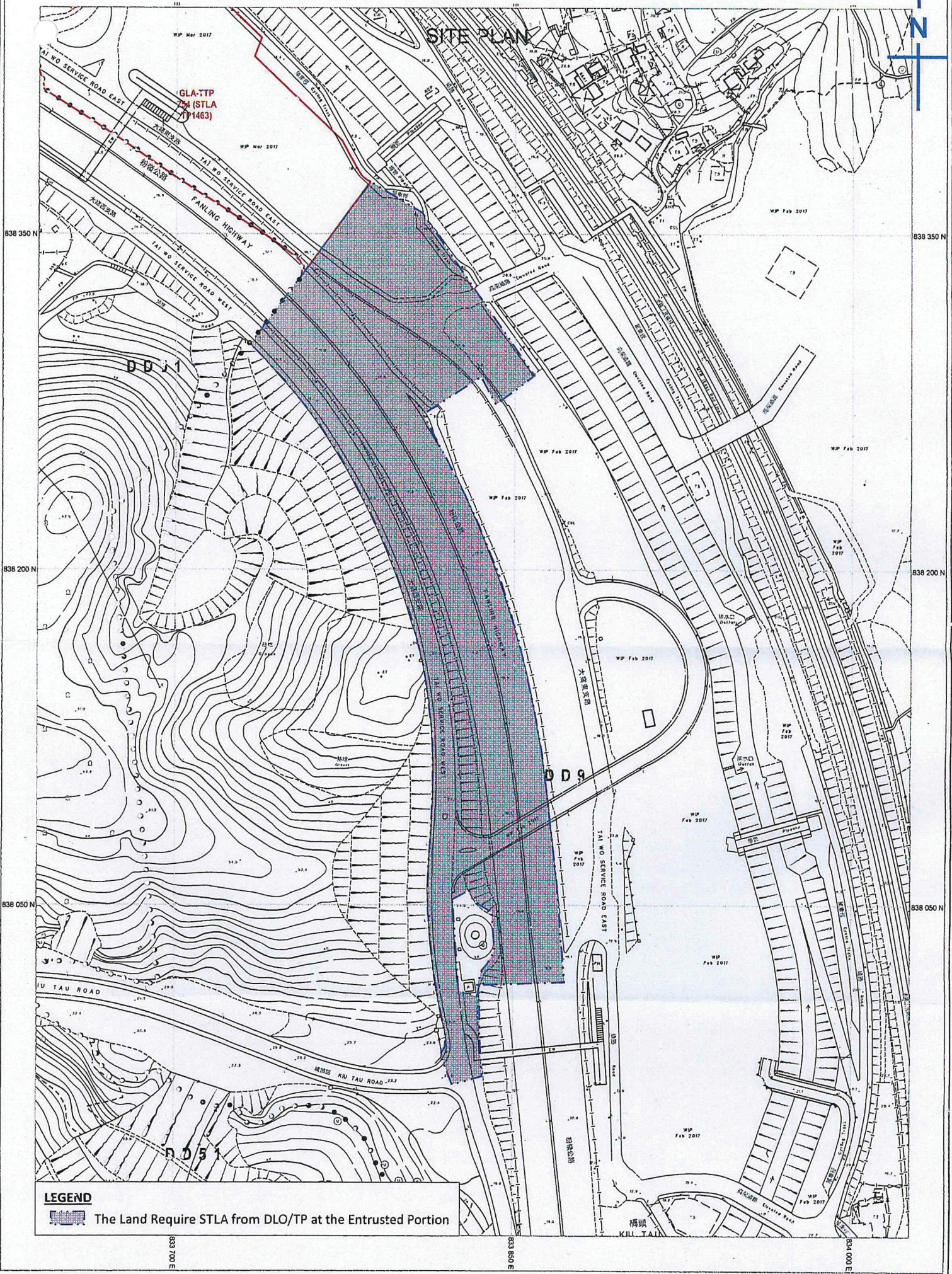
SITE PLAN



LEGEND

 The Land Require STLA from DLO/TP at the Entrusted Portion

833 700 E

833 800 E

834 000 E

PW? Item No. 3720TH Widening of Tolo Highway/Fanling Highway between island House Interchange and Fanling - Stage 2

SITE PLAN

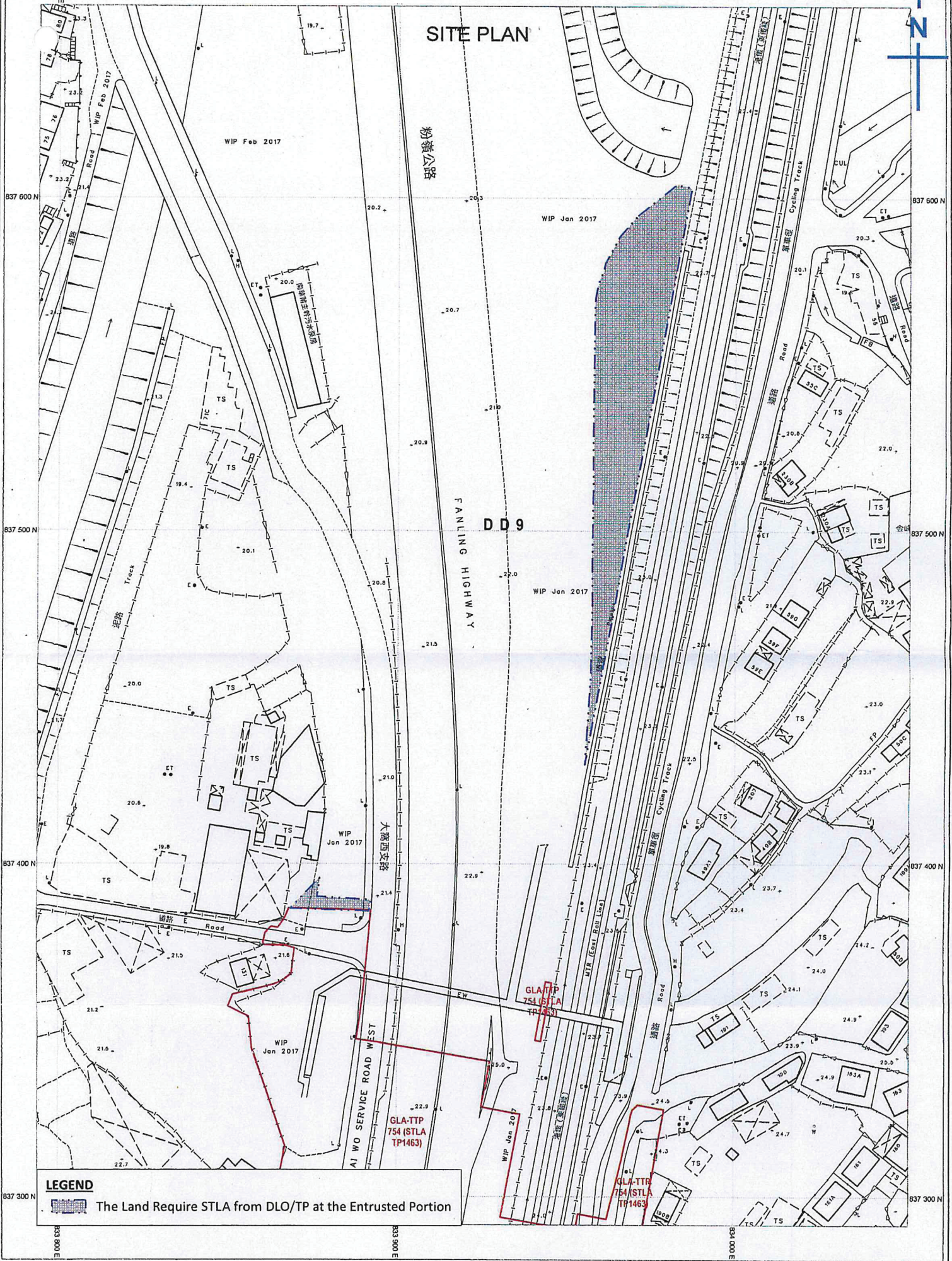

DD9

粉嶺公路

FANLING HIGHWAY

大窩西支路

AI WO SERVICE ROAD WEST

MTR (East Rail Line)

Cycling Track

LEGEND

 The Land Require STLA from DLO/TP at the Entrusted Portion

GLA-TTP
754 (STLA
TP1463)

GLA-TTR
754 (STLA
TP1463)